

6.6 A Current Controlled Halogen - Reflector Lamps for Series Operation

6.6 A reflector lamps for airfield lighting that provide accurate filament alignment for precision optics

Areas of application

- Airfield Lighting



Product features and benefits

- Low maintenance costs due to long lamp life
- Reliable and consistent light output enhances visibility over the life of the lamp
- FAA approved in conjunction with many OEM fixtures
- Durable construction provides resistance to the effects of vibration
- Broad product portfolio for runway, taxiway, and approach lighting
- IR radiation provides guidance in low visibility conditions
- Flicker-free operation
- Ability to reduce light output when needed
- Mercury-free



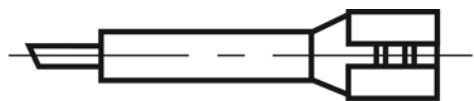

Connector A, female

PK30d Connector A female

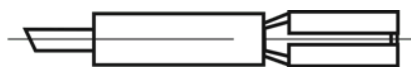

Connector B, female round

PK30d Connector B female round

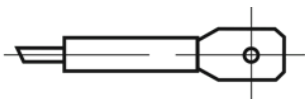

Connector C, male flat

PK30d Connector C male flat

Product family datasheet

Technical data

Product description	General Product Information			
	Product number (Americas)	Product name (Americas)	Lamp type	Global order reference
64333 A 40-15	58899	6.6A 40W MR11 64333A 20/CS 1/SKU	SINGLE ENDED	64333 A 40-15
64333 B 40-15	58889	6.6A 40W MR11 64333B 20/CS 1/SKU	SINGLE ENDED	64333 B 40-15
64336 A 62-15	58493	6.6A 62W MR16 64336A 20/CS 1/SKU	SINGLE ENDED	64336 A 62-15
64337 A 45-15	58907	6.6A 45W MR16 64337A 45-15 20/CS 1/SKU	SINGLE ENDED	64337 A 45-15
64337 B 45-15	58908	6.6A 45W MR16 64337B 45-15 20/CS 1/SKU	SINGLE ENDED	64337 B 45-15
64339 A 105-10	58953	6.6A/105MR16/6433 9A 20/CS 1/SKU	SINGLE ENDED	64339 A 105-10
64333 C 40-15	4008321104885	6.6A 40W MR11 64333C 20/CS 1/SKU		64333 C 40-15
64337 A 48-15	58891	6.6A 48W MR16 64337A 48-15 20/CS 1/SKU	SINGLE ENDED	64337 A 48-15
64339 AC 105-10	58960	6.6A 105W MR16 64339AC 20/CS 1/SKU	SINGLE ENDED	63339 AC 105-10
64337 B 48-15	4008321105226	6.6A 48W MR16 64337B 20/CS 1/SKU		64337 B 48-15
64337 C 48-15	4008321105240	6.6A 48W MR16 64337C 20/CS 1/SKU		64337 C 48-15
64339 B 105-10	4008321105462	6.6A 105W MR16 64339B 20/CS 1/SKU	SINGLE ENDED	64339 B 105-10
64339 C 105-10	58963	6.6A 105W MR16 64339C 20/CS 1/SKU	SINGLE ENDED	64339 C 105-10
64338 AC 48-10	58894	6.6A 48W MR16 64338AC 20/CS 1/SKU	SINGLE ENDED	64338 AC 48-10
64331 SP-A 30-10	58506	6.6A 30W MR16 64331A SP 20/CS 1/SKU		64331 SP-A 30-10
64331 FL-A 30-10	58938	6.6A 30MR16 64331AC FL 20/CS 1/SKU	SINGLE ENDED	64331 FL-AC 30W

Product description	Electrical Data	Photometric Data		
	Nominal wattage	Nominal luminous flux	Axial luminous intensity	Color temperature
64333 A 40-15	40 W	10000 lm	12700 cd	3400 K
64333 B 40-15	40 W	10000 lm	12700 cd	3400 K
64336 A 62-15	62 W	28000 lm	31500 cd	3250 K
64337 A 45-15	45 W	19000 lm	21000 cd	3200 K

Product family datasheet

Product description	Electrical Data	Photometric Data		
	Nominal wattage	Nominal luminous flux	Axial luminous intensity	Color temperature
64337 B 45-15	45 W	19000 lm	21000 cd	3200 K
64339 A 105-10	105 W	30000 lm	32000 cd	3300 K
64333 C 40-15	40 W	10000 lm	12700 cd	3400 K
64337 A 48-15	48 W	20000 lm	23000 cd	3200 K
64339 AC 105-10	105 W	30000 lm	32000 cd	3300 K
64337 B 48-15	48 W	20000 lm	23000 cd	3200 K
64337 C 48-15	48 W	20000 lm	23000 cd	3200 K
64339 B 105-10	105 W	30000 lm	32000 cd	3300 K
64339 C 105-10	105 W	30000 lm	32000 cd	3300 K
64338 AC 48-10	48 W	23000 lm	27000 cd	3300 K
64331 SP-A 30-10	30 W		18000 cd	
64331 FL-A 30-10	30 W			

Product description	Color rendering index Ra	Physical Attributes & Dimensions		
		Lamp base	Diameter (in)	Diameter
64333 A 40-15	100	Leads w/female flat connectors	1.390 in	35.3 mm
64333 B 40-15	100	Leads w/female round connector	1.390 in	35.3 mm
64336 A 62-15	100	Leads w/female flat connectors	1.984 in	50.4 mm
64337 A 45-15	100	Leads w/female flat connectors	1.984 in	50.4 mm
64337 B 45-15	100	Leads w/female round connector	1.984 in	50.4 mm
64339 A 105-10	100	Leads w/female flat connectors	1.984 in	50.4 mm
64333 C 40-15		Leads w/male flat connectors		35.3 mm
64337 A 48-15	100	Leads w/male flat connectors	1.984 in	50.4 mm
64339 AC 105-10		Leads w/male and female flat c	1.984 in	50.4 mm
64337 B 48-15		Leads w/female round connector		50.4 mm
64337 C 48-15		Leads w/male flat connectors		50.4 mm
64339 B 105-10		Leads w/female round connector	1.984 in	50.4 mm
64339 C 105-10		Leads w/male flat connectors	1.984 in	50.4 mm
64338 AC 48-10	100	Leads w/male and female flat c	1.984 in	50.2 mm
64331 SP-A 30-10	100	Leads w/female flat connectors	1.984 in	50.4 mm
64331 FL-A 30-10	100	Leads w/male and female flat c	1.984 in	50.4 mm

Product family datasheet

Product description	Length	Length with base excl. base pins/connection	Connector: presence	Connection with cable
64333 A 40-15	35.0 mm	37.00 mm	Yes	Yes
64333 B 40-15	35.0 mm	37.00 mm	Yes	Yes
64336 A 62-15	45.0 mm	45.00 mm	Yes	Yes
64337 A 45-15	45.0 mm	45.00 mm	Yes	Yes
64337 B 45-15	45.0 mm	45.00 mm	Yes	Yes
64339 A 105-10	48.0 mm	48.00 mm	Yes	Yes
64333 C 40-15	35.0 mm	37.00 mm	Yes	Yes
64337 A 48-15	45.0 mm	45.00 mm	Yes	Yes
64339 AC 105-10	48.0 mm	48.00 mm	Yes	Yes
64337 B 48-15	45.0 mm	45.00 mm	Yes	Yes
64337 C 48-15	45.0 mm	45.00 mm	Yes	Yes
64339 B 105-10	48.0 mm	48.00 mm	Yes	Yes
64339 C 105-10	48.0 mm	48.00 mm	Yes	Yes
64338 AC 48-10	44.0 mm	45.00 mm	Yes	Yes
64331 SP-A 30-10	48.0 mm		Yes	Yes
64331 FL-A 30-10	48.0 mm		Yes	Yes

Product description	Mains terminals	Product weight	Operating Conditions	Lifetime Data
			Burning position	Nominal lifetime
64333 A 40-15	Leads w/female flat connectors	15.00 g	h45	1500 hr
64333 B 40-15	Leads w/female round connectors	15.00 g	h45	1000 hr
64336 A 62-15	Leads w/female flat connectors	15.00 g	Horizontal	1500 hr
64337 A 45-15	Leads w/female flat connectors	31.00 g	Horizontal	1500 hr
64337 B 45-15	Leads w/female round connectors	31.00 g	Horizontal	1500 hr
64339 A 105-10	Leads w/female flat connectors	31.10 g	Horizontal	1000 hr
64333 C 40-15	Leads w/male flat connectors	15.00 g	h45	1500 hr

Product family datasheet

Product description	Mains terminals	Product weight	Operating Conditions	Lifetime Data
			Burning position	Nominal lifetime
64337 A 48-15	Leads w/female flat connectors	31.00 g	Horizontal	1500 hr
64339 AC 105-10	Leads w/male and female flat connectors	31.10 g	Horizontal	1000 hr
64337 B 48-15	Leads w/female round connectors	31.00 g	Horizontal	1500 hr
64337 C 48-15	Leads w/male flat connectors	15.00 g	Horizontal	1500 hr
64339 B 105-10	Leads w/female round connectors	31.10 g	Horizontal	1000 hr
64339 C 105-10	Leads w/male flat connectors	31.10 g	Horizontal	1000 hr
64338 AC 48-10	Leads w/male and female flat connectors	24.56 g	Horizontal	1000 hr
64331 SP-A 30-10	Leads w/female flat connectors	23.00 g		1000 hr
64331 FL-A 30-10		25.00 g		1000 hr

Environmental & Regulatory Information Information according Art. 33 of EU Regulation (EC) 1907/2006 (REACH)

Product description	Primary article identifier	Declaration no. in SCIP database	Candidate list substance 1
64333 A 40-15	4008321166340	No declarable substances contained	No declarable substances contained
64333 B 40-15	4008321104731	No declarable substances contained	No declarable substances contained
64336 A 62-15	4008321186713	No declarable substances contained	No declarable substances contained
64337 A 45-15	4008321102515	No declarable substances contained	No declarable substances contained
64337 B 45-15	4008321104700	No declarable substances contained	No declarable substances contained

Product family datasheet

Environmental & Regulatory Information Information according Art. 33 of EU Regulation (EC) 1907/2006 (REACH)			
Product description	Primary article identifier	Declaration no. in SCIP database	Candidate list substance 1
64339 A 105-10	4008321101600	No declarable substances contained	No declarable substances contained
64333 C 40-15	4008321104885	No declarable substances contained	No declarable substances contained
64337 A 48-15	4008321102737	No declarable substances contained	No declarable substances contained
64339 AC 105-10	4008321105424	No declarable substances contained	No declarable substances contained
64337 B 48-15	4008321105226	No declarable substances contained	No declarable substances contained
64337 C 48-15	4008321105240	No declarable substances contained	No declarable substances contained
64339 B 105-10	4008321105462	No declarable substances contained	No declarable substances contained
64339 C 105-10	4008321105486	No declarable substances contained	No declarable substances contained
64338 AC 48-10	4008321105301	No declarable substances contained	No declarable substances contained
64331 SP-A 30-10	4008321102560	No declarable substances contained	No declarable substances contained
64331 FL-A 30-10	4008321102584	No declarable substances contained	No declarable substances contained

Product family datasheet

Safety advice

To prevent personal injury or damage to property, halogen lamps may only be operated in suitable luminaires designed with suitable mechanisms (protective shields, grids, etc.) to ensure that in the event of a lamp bursting no parts/shards can escape and that during operation no ultraviolet radiation can escape. There must also be a warning sign to indicate that the lamps give off high levels of heat. Detailed information is available on request.

Application advice

For more detailed application information and graphics please see product datasheet.

Disclaimer

Subject to change without notice. Errors and omission excepted. Always make sure to use the most recent release.